



Submittal Data Information

101-077

Model 007-IFC® Cartridge Circulator

Effective: June 7, 2010

Supersedes: July 11, 2007

Job: _____ Engineer: _____ Contractor: _____ Rep: _____

ITEM NO.	MODEL NO.	IMP. DIA.	G.P.M.	HEAD/FT.	H.P.	ELEC. CHAR.

Features

- Integral Flow Check (IFC®)
 - Simplifies piping
 - Prevents reverse flow and gravity flow
 - Eliminates separate in-line flow check
 - Reduces installed cost
 - Improves system performance
 - Easy to service
- Unique replaceable cartridge-field serviceable
- Unmatched reliability-maintenance free
- Quiet, efficient operation
- Self lubricating, No mechanical seal
- Wide range of applications
- Cast Iron or Stainless Steel construction
- Flanged connections

Application

- Hydronic Heating/Cooling
- Radiant
- Indirect Water Heaters
- Hydro-Air Fan Coils
- Domestic Water Recirculation (Stainless Steel only)

The 007-IFC is designed to simplify piping, reduce installation costs and improve system performance when zoning with 00® circulators. By locating the IFC inside the pump, a separate in-line flow check is eliminated. The low pressure drop of the IFC increases flow performance vs. in-line flow checks. Both the IFC and the cartridge are easily accessed for removal and service.

Pump Dimensions & Weights

Model	Casing	A		B		C		D		E		F		Ship Wt.	
		in.	mm	in.	mm	in.	mm	in.	mm	in.	mm	in.	mm	lbs.	Kg
007-F5-7 IFC	Cast Iron	6-1/8	156	4-1/2	114	3-3/16	81	2-15/16	75	5	127	6-3/8	162	9	4.0
007-F5-8 IFC	Cast Iron	5-7/8	149	4-1/2	114	3-3/16	81	2-15/16	75	5	127	6-3/8	162	9	4.0
007-SF5 IFC	S.Steel	6-1/8	156	4-1/2	114	3-3/16	81	2-15/16	75	5	127	6-3/8	162	9	4.0

Materials of Construction

- Casing (Volute): Cast Iron or Stainless Steel
- Integral Flow Check (IFC®):
 Body, Plunger Acetal
 O-ring Seals EPDM
 Spring Stainless Steel
- Stator Housing: Steel
- Cartridge: Stainless Steel
- Impeller: Non-Metallic
- Shaft: Ceramic
- Bearings: Carbon
- O-Ring & Gaskets: EPDM

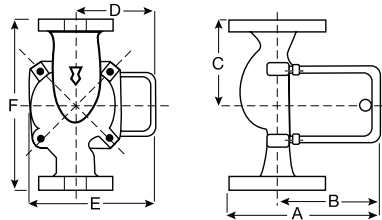

Mounting Positions

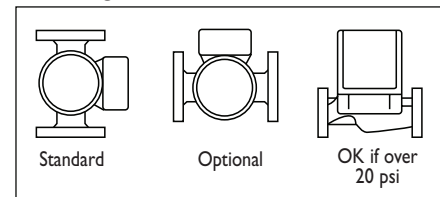

Electrical Data

Model	Volts	Hz	Ph	Amps	RPM	HP
Cast Iron	115	60	1	.71	3250	1/25
Stainless Steel	115	60	1	.76	3250	1/25

Motor Type: Permanent Split Capacitor Impedance Protected

Motor Options: 220/50/1, 220/60/1, 230/60/1, 100/110/50/60/1

Flange Orientation

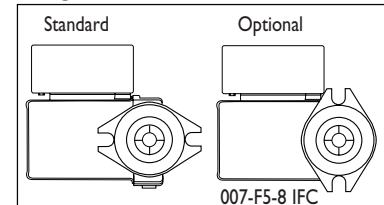

Model Nomenclature

- F – Cast Iron, Flanged
 SF – Stainless Steel, Flanged
 IFC® – Integral Flow Check
- Variations:**
- Z – Zoning Circulator
 VR – Variable Speed Outdoor Reset
 VS – Variable Speed Set Point
 VV – Variable Speed Variable Voltage
 J – Bronze Cartridge with Cast Iron Casing

Performance Data

- Flow Range: 0 - 17 GPM
 Head Range: 0 - 8.5 Feet
 Minimum Fluid Temperature: 40°F (4°C)
 Maximum Fluid Temperature: 230°F (110°C)
 Maximum Working Pressure: 125 psi
 Connection Sizes: 3/4", 1", 1-1/4", 1-1/2" Flanged



FOR INDOOR USE ONLY

Performance Field - 60Hz

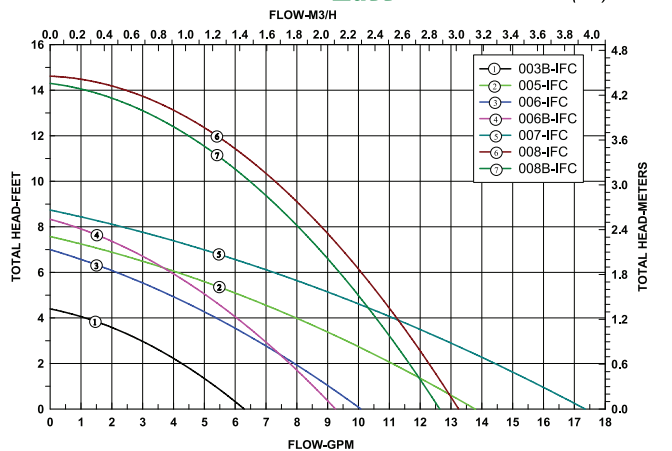

NSF® ≤ .25% Lead
 Complies with California Health and Safety Code Section 116875 / AB1953 and Vermont Act 193



Taco, Inc., 1160 Cranston Street, Cranston, RI 02920 | Tel: (401) 942-8000 | FAX: (401) 942-2360
 Taco (Canada), Ltd., 8450 Lawson Road, Suite #3, Milton, Ontario L9T 0J8 | Tel: (905) 564-9422 | FAX: (905) 564-9436
 Visit our web site: www.TacoComfort.com | Printed in USA | ©2015 Taco, Inc.

